

NOZZLE SCHEDULE			
ITEM	QTY.	NAME	DESCRIPTION
N1	1	INLET	10"-300# RFSO ASME B16.5
N2	1	OUTLET	10"-300# RFSO ASME B16.5
N3	1	DRAIN	2" NPT 3000# COUPLING
N4	1	VENT	1/2" NPT 3000# COUPLING
N5	2	W.G. CONNECTIONS	1/2" NPT 3000# COUPLING

REV	DATE	CHANGE	ECR	BY	APP
A	3/19/02	NEW ISSUE	A347	GC	VH
B	6/12/02	ENGINEERING CHANGE	A608	FJM	VA
C	11/1/05	REVISED TITLE BLOCK	D507	FM	LH

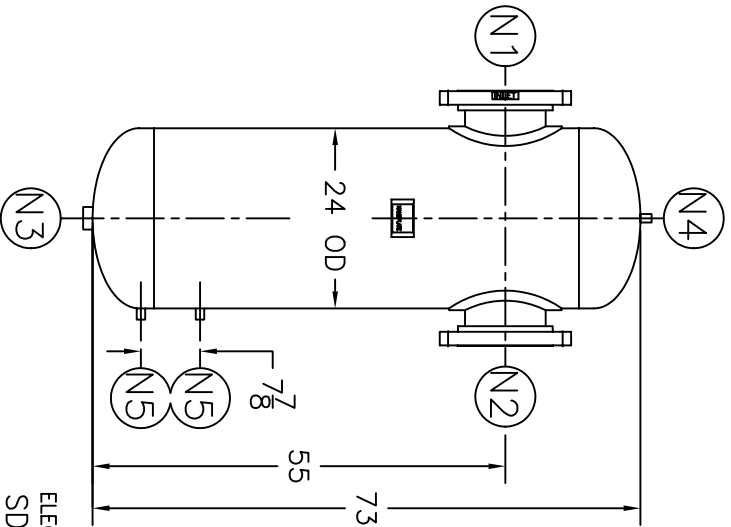
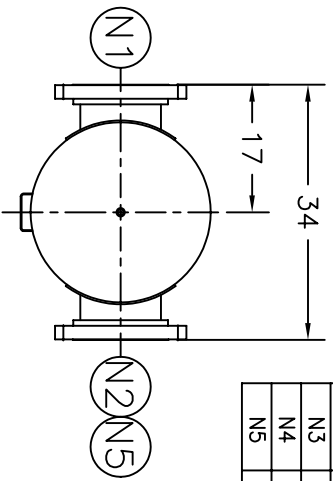

NOTES:

- UNITS ARE TO BE DESIGNED, FABRICATED, AND CODE STAMPED (IF REQ'D) IN ACCORDANCE WITH ASME B & PV CODE, SECTION VIII, DIVISION 1 IN COMPLIANCE TO CURRENT PUBLISHED ADDENDA.
- ALL DIMENSIONS ARE IN INCHES.
- ALL BOLT HOLES ARE TO STRADDLE NATURAL CENTERLINES.
- SHIPPING WEIGHT: 1200 POUNDS.
- DESIGN DATA:
 - DESIGN PRESSURE-- 500 PSIG
 - DESIGN TEMPERATURE-- 650° F
 - MIN. DESIGN METAL TEMP.-- -20° F @ 500 PSIG
 - HYDROTEST PRESSURE-- 650 PSIG
 - CORROSION ALLOWANCE-- 0 INCHES
- MATERIAL: CARBON STEEL.

ELECTRONIC FILE NAME:
SD10T500C.DWG

TOLERANCES UNLESS OTHERWISE SPECIFIED
PER ENGINEERING STANDARD ES- --

UNAUTHORIZED USE, MANUFACTURE OR
REPRODUCTION IN WHOLE OR IN PART IS
PROHIBITED. DRAWING, DESIGN AND
OTHER DISCLOSURES PROPERTY OF
EATON FILTRATION, LLC



EATON FILTRATION, LLC
900 FAIRMOUNT AVENUE, ELIZABETH, NEW JERSEY 07207
NAME
**10" TYPE "T" GAS/LIQUID
SEPARATOR 300# FLG (CSTL)**

CUSTOMER:
REG. NO.:
P.O. NO.:
TAG NO.:
PART NO.: 10T500C,10T500CU

DRAWN	GC	DATE	CHECKED	FJM	DATE	3/19/02	
APP	VH	DATE	SCALE	NTS	ECR	A347	
SIZE	DWG	NO	SD10T500C				REV
A							C