

## Pneumatic cylinder



- According to 15552
- Metal version
- Cylinder tube aluminium profile
- Flat Design
- Screwed inside
- Adjustable end of stroke cushioning
- Incorporated magnetic piston

The double-acting cylinder is equipped with magnetic piston and adjustable end of stroke cushioning.

The adjusting screws for the end of stroke cushioning are located on the port side and can be adjusted with an hexagon socket screw key.

The adjusting screws are secured against unscrewing.

Technical Data	
<b>Piston diameter</b>	32...125 mm
<b>Materials</b>	
Piston rod	Stainless steel
Cylinder head	Die-cast aluminium painted,
Cylinder tube	Anodised aluminium profile
<b>Seal material</b>	PU/NBR
<b>Control medium</b>	Filtered compressed air
<b>Temperature range</b>	-20...+80°C
<b>Pressure range<sup>1)</sup></b>	1...10 bar
<b>Strokes</b>	10...2800 mm

<sup>1)</sup> Pressure values [bar]: Overpressure with respect to atmospheric pressure

Other versions on request

### Force chart

Piston-diameter [mm]	Double-acting cylinder	
	Extension force [N]	Retraction force [N]
32	434	373
40	678	570
50	1060	890
63	1682	1513
80	2713	2448
100	4239	3974
125	6623	6189

Operating pressure 6 bar  
The internal friction is considered.

Permissible side load (in N) for cylinder TZU002

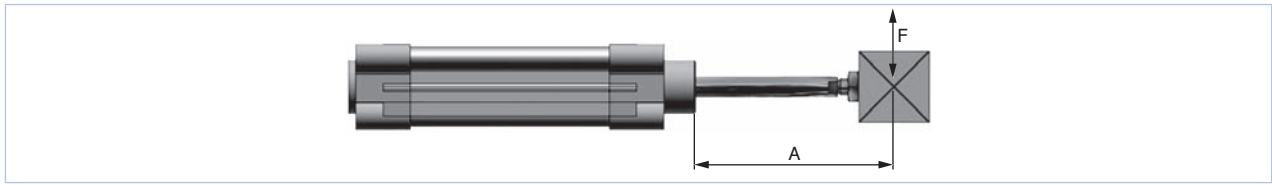

Piston diameter [mm]	Distance A (in mm)											
	25	40	50	80	100	125	160	200	250	320	400	500
32	75	55	50	40	34	28	23	20	16	12	9	7
40	175	150	130	105	91	78	62	55	45	35	28	21
50 and 63	220	180	170	130	120	105	90	80	65	52	43	33
80 and 100	500	450	400	350	310	270	230	205	180	150	125	100
125	810	710	680	590	520	470	420	390	330	270	230	200

Dimension [mm]

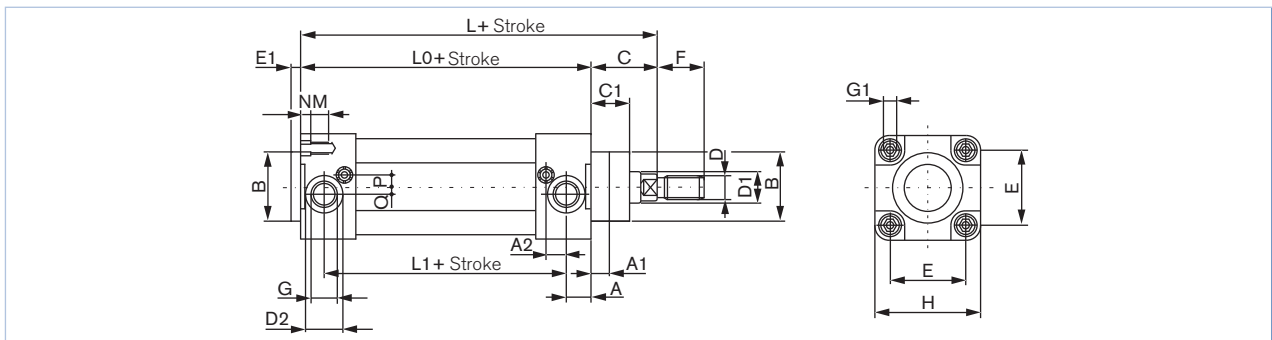

	Piston diameter						
	32 [mm]	40 [mm]	50 [mm]	63 [mm]	80 [mm]	100 [mm]	125 [mm]
A	10	12	14	16	18	20	25
A1	6.5	8	13	14	12	14	20
A2	10	10	10	10	12	12	10
B	30	35	40	45	45	55	60
C	26	30	37	37	46	51	65
C1	16	20	25	25	33	38	45
D	M10 x 1.25	M12 x 1.25	M16 x 1.5	M16 x 1.5	M20 x 1.5	M20 x 1.5	M27 x 2
D1	12	16	20	20	25	25	32
D2	15	19	19	23	23	27	27
E	32.5	38	46.5	56.5	72	89	110
E1	4	4	4	4	4	4	6
F	22	24	32	32	40	40	54
G	G 1/8	G 1/4	G 1/4	G 3/8	G 3/8	G 1/2	G 1/2
G1	M6	M6	M8	M8	M10	M10	M12
H	46	54	64.5	75.5	94	111	135
L	120	135	143	158	174	189	225
L0	94	105	106	121	128	138	160
L1	74	81	78	89	92	98	145
M	14.5	14.5	17.5	17.5	21.5	21.5	25.5
N	4.5	4.5	5.5	5.5	5.5	5.5	6.5
P	6	6	6	6	10	10	12
Q	4	4	6	6	7	7	8

## Ordering chart cylinder

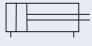
Circuit function	Piston diameter [mm]	Stroke [mm]	Item no. double-acting
Double-acting 	32	50	780 242
		100	780 244
		160	780 246
	40	50	780 251
		100	780 253
		160	780 255
	50	50	780 260
		100	780 262
		160	780 264
		200	780 265
	63	50	780 269
		100	780 271
		160	780 273
		200	780 274
	80	100	780 280
		160	780 282
		200	780 283
	100	100	780 289
		160	780 291
		200	780 292
	125	100	780 298
160		780 300	

- The delivery of the cylinder includes a piston rod nut.
- Other versions on request.

To find your nearest Bürkert office, click on the orange box →

[www.burkert.com](http://www.burkert.com)

If case of special conditions,  
please consult for advice.

Subject to alteration.  
© Christian Bürkert GmbH & Co. KG

1511/1\_EU-en\_00895297